

Sold



182 VALLEY DR, Doonan



## UNDER CONTRACT

Situated on 1.5 level acres in a fervently sought after location in Doonan is one of Noosa Hinterlands most iconic properties. Designed by the much applauded architect Stephen Kidd, Liberty Hall was built on one level for ease of access and uniquely designed to take in maximum light and air flow without compromising on privacy.

Almost the entire north facing side of the house consists of glass stacker doors and mitred glass walls overlooking a sparkling pool, lush lawn and tropical gardens, set just high enough above the Noosa Valley Golf Course's third fairway to provide absolute privacy.

Classical architectural overtones pervade the interior, allowing for many possible styles of interior decorating.

The well formulated floor plan works at a functional level with ensuited bedrooms throughout, two with dressing rooms, two with built in robes and three with garden views.

The guest quarters lies at one end, the master suite at the other

🏠 4 🍷 4 🚗 9 🌊 📄

6,129m2

**Price** SOLD  
**Property Type** Residential  
**Property ID** 114  
**Land Area** 6,129 m2

### Agent Details

### Office Details

David Berns Real Estate  
 0408 629 438



and the central open plan living flows out to a large undercover entertainment area and wide verandahs that span the entire length of the home.

Acreage properties of this caliber, with golf course frontage, epitomize luxury country living in the Hinterland with convenient access to all that Noosa has to offer, they do not come to market often.

Additional features:

- \*4 car garage accommodation and formal porte-cochere
- \*Rooms for independent interests – study, artist studio and media room
- \*Security intercom to remote controlled entrance gates
- \*Ducted air con to central living areas, split systems to the bedrooms
- \*5kw Solar power system, quality water bore and 20,000 gallon rainwater tank
- \*Gas cooktop, gas hot water system
- \*Ducted vacuum system, fully irrigated gardens.
- \*Salt water in-ground pool
- \*All just 10-15 minutes to the shops, restaurants and beaches of Noosa

The above information provided has been furnished to us by the vendor/s. We have not verified whether or not that information is accurate and do not have any belief in one way or the other in its accuracy. We do not accept any responsibility to any person for its accuracy and do no more than pass it on. All interested parties should make and rely upon their own inquiries in order to determine whether or not this information is in fact accurate.

# 182 Valley Dve, Doonan

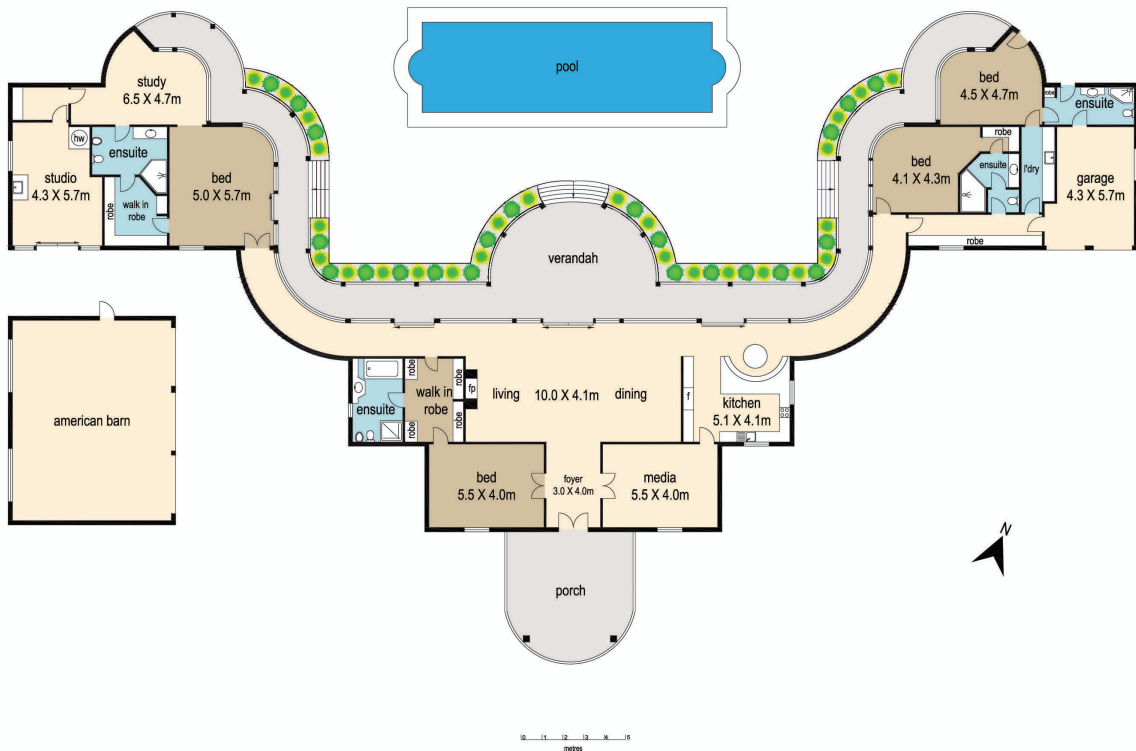

= 415m<sup>2</sup>  
 = 209m<sup>2</sup>  
**TOTAL = 624m<sup>2</sup>**

**DISCLAIMER :** While every endeavour has been made to verify the correct details in this illustration neither the agent, vendor nor the contracted illustrators/typesetters accept liability for any error or omission. Information intended to be relied upon should be independently verified. Be advised that any measurements are made approx from the widest point to that area.

www.floorplansplus.com.au

**FLOORPLANS PLUS**

m 0404 430 300  
 floor@floorplansplus.com.au