

Sold



184 GUMBOIL RD, Tinbeerwah



UNDER CONTRACT

Tucked away on a little piece of paradise, this neat as a pin home was built in Queenslander style, to function in harmony with our climate. Designed to take advantage of prevailing breezes with wide verandahs on the northern and eastern sides and loads of oversized windows & sliders allowing natural light to filter through every room. All the work is done, just move in. Brand new kitchen with soft close cabinetry and Ceasarstone benches, new bathrooms & laundry, freshly painted inside and out, new fans, led lighting, air con and an infinity edge inground pool with privacy and views over the property.

Features in a nutshell:

- *Set well back from the road on a private 1.96 acres
- *Quality hardwood polished floors and good ceiling height throughout
- *Numerous established feature trees, landscaped gardens and veggie beds
- *Workshop/studio and storage room adjoining the 3 bay carport

3 3 5

7,952 m2

Price

SOLD for
\$73,000

**Property
Type**

Residential

Property ID 133

Land Area 7,952 m2

Floor Area 241.54 m2

Agent Details

Office Details

David Berns Real Estate
0408 629 438

db davidberns
REAL ESTATE

*New kitchen with ample storage space, new appliances and soft close drawers

*Master suite complete with ensuite and walk-in robe

*New bathrooms and laundry in soft marbled whites paired with fresh brights

*New inground pool with hardwood decks and glass fencing

*Fully fenced at the rear with quality post and rail gated access

*Two garden sheds and animal shelter, perfect for our bigger four legged friends

*Approx 12,000 gallons rainwater and a 1.5kw solar power system to offset costs

*Fully insulated roof cavity and new blinds throughout

*NBN satellite aerial for fast wireless internet

*What more could you want all just a 5 min drive from Noosa

The above information provided has been furnished to us by the vendor/s. We have not verified whether or not that information is accurate and do not have any belief in one way or the other in its accuracy. We do not accept any responsibility to any person for its accuracy and do no more than pass it on. All interested parties should make and rely upon their own inquiries in order to determine whether or not this information is in fact accurate.

184 Gumboil Road, Tinbeerwah

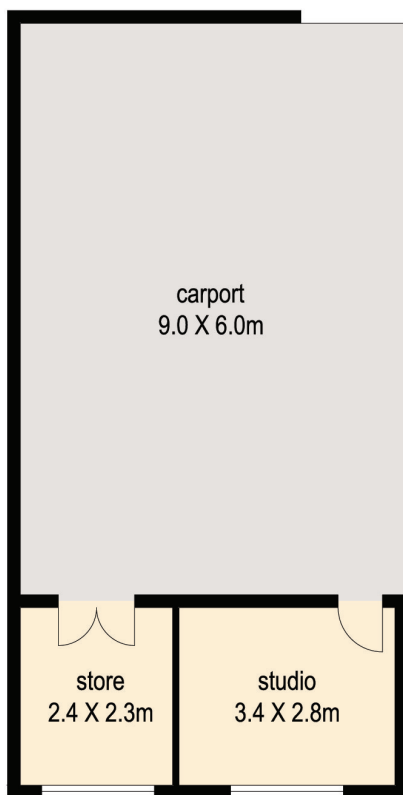
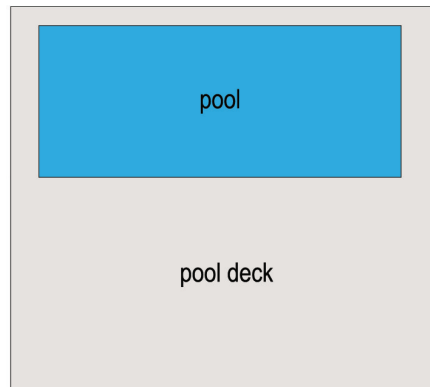

nltp



0 1 2 3 4 5

metres

= 132m²
 = 113m²
TOTAL = 245m²

DISCLAIMER : While every endeavour has been made to verify the correct details in this illustration neither the agent, vendor nor the contracted illustrators/typesetters accept liability for any error or omission.
Information intended to be relied upon should be independently verified.
Be advised that any measurements are made approx from the widest point to that area.