

Sold

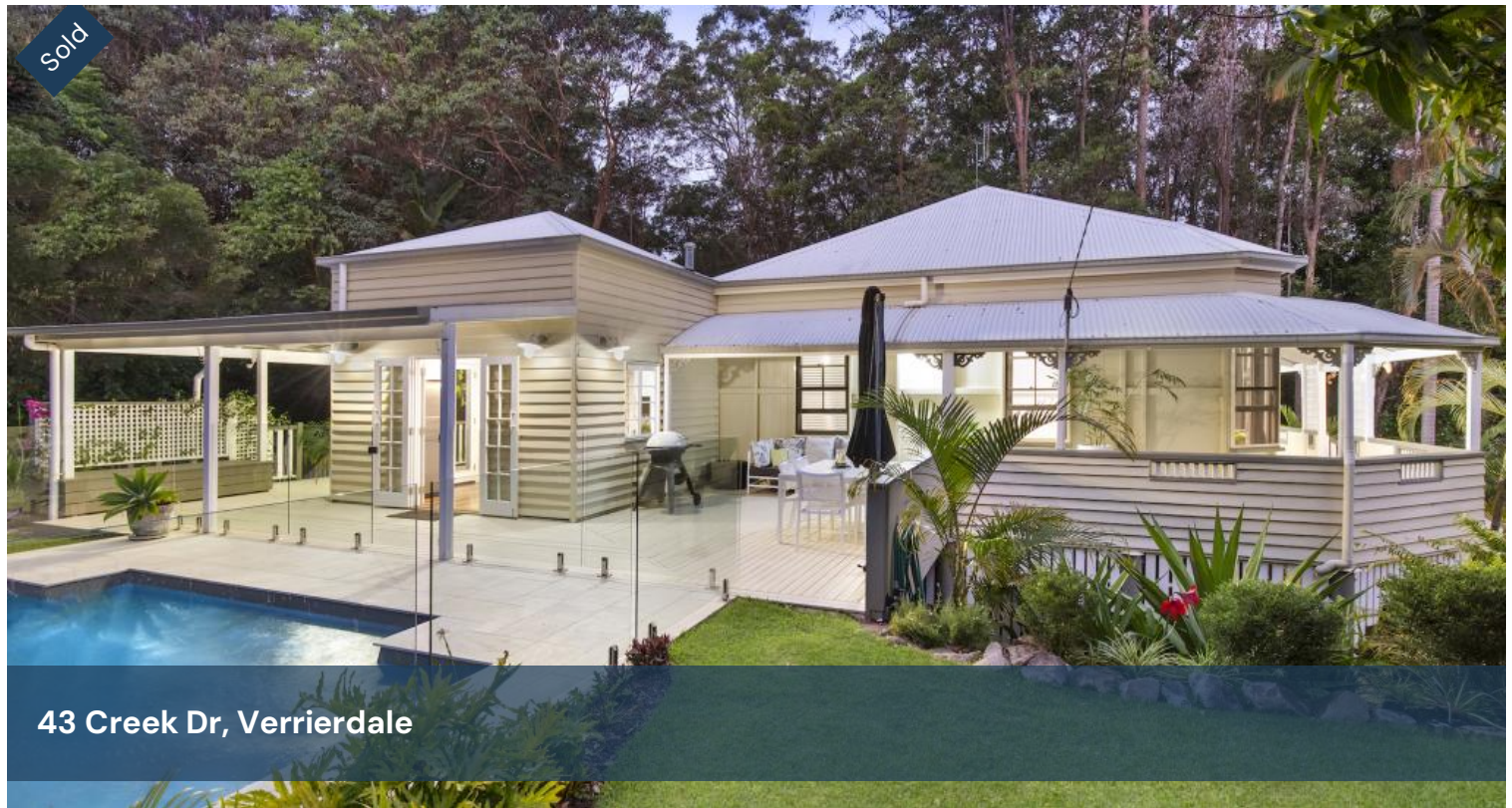

43 Creek Dr, Verrierdale



PRETTY AS A PICTURE

This beautifully renovated 1904 Colonial Queenslander features 3.3 meter ceilings, hardwood construction, polished timber floors and French doors leading to full length verandahs spanning the north, west and southern sides of the home making the most of the sun's passage and prevailing breezes, a design that has worked perfectly with the Queensland climate since early settler days.

A spacious open plan living layout provides the type of flow required of modern living with same level access to an ionised freshwater inground swimming pool. The ensuited master and second bedroom are also on this same level, while the other two bedrooms and additional bathroom are situated downstairs providing the perfect space for kids or guests.

All this, nestled amongst idyllic gardens at the end of a quiet cul-de-sac just 10mins from Noosa and 5mins to Eumundi.

Features include:

- Smartstone marbled kitchen tops, soft close drawers, gas range cooker & 2 integrated dishwasher drawers

🏠 4 🛏 3 🚗 3 📏 4,388 m2

Price	SOLD
Property Type	Residential
Property ID	205
Land Area	4,388 m2

Agent Details

Heidi Woodman – 0419 818 418

Office Details

David Berns Real Estate
0408 629 438



- Wood combustion burner, 3 split air ons & fans throughout for year round comfort
- Pool with Bionizer filtration system with auto PH, oxidiser and auto top up
- Beautiful established gardens including a variety of fruit trees– lime, lemon, grapefruit, tangelo, mandarin, lychee, macadamia, star fruit, turmeric & ginger
- Bitumen driveway and 3 car lock up parking
- Quality gutter guard throughout, Davey whole house filtration system
- Water pump– DAB Esybox PSI adjustable (European manufacture) new Jan 2019
- Solar hot water system & approx. 88,000 litres rainwater tank capacity



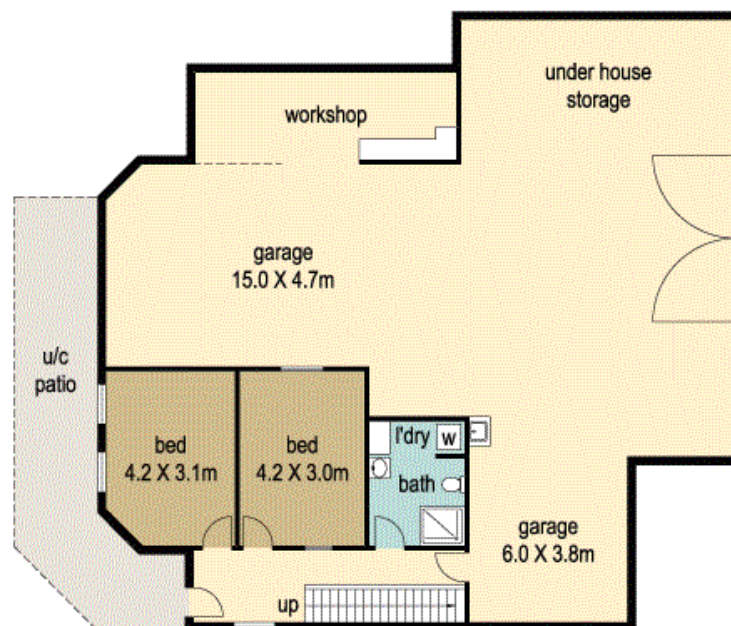
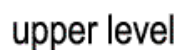

The above information provided has been furnished to us by the vendor/s. We have not verified whether or not that information is accurate and do not have any belief in one way or the other in its accuracy. We do not accept any responsibility to any person for its accuracy and do no more than pass it on. All interested parties should make and rely upon their own inquiries in order to determine whether or not this information is in fact accurate.

db davidberns
REAL ESTATE

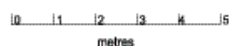

lower level





 = 336m²
 = 108m²
TOTAL = 444m²

AIMER : While every endeavour has been made to verify the correct details in this illustration neither the agent, vendor nor the contracted illustrators/typesetters accept liability for any error or omission.
Information intended to be relied upon should be independently verified.
Be advised that any measurements are made approx from the widest point to that area.