

Sold



31 Whispering Gum Ave, Eumundi



JUST MOVE IN!

Built in 2018, this beautifully presented family home offers space enough for everyone to enjoy some time to themselves. Situated in a quiet no through street with ample level grassed areas for kids to run and pockets of rainforest with a permanent spring-fed creek.

There's really not much to do here but move in, add some of your own touches and enjoy the peace & quiet of one of the best locations in the Noosa Hinterland.

- Set on 1.61 acres, 4 bedroom 3 bathroom and multiple living zones
- Weatherboard cladding construction with colorbond roof in neutral greys & whites
- Beautifully fitted with on trend greys and soft stone colours throughout
- Large Shaker style kitchen with walk in pantry, plus butlers wet bar pantry
- Stone tops, island breakfast bar and servery bar with hydraulic

🛏 4 🚿 3 🚗 4

Price SOLD for
\$957,000

Property Type Residential

Property ID 255

Agent Details

Heidi Woodman – 0419 818 418

Office Details

David Berns Real Estate
0408 629 438



window to outdoors

- 900mm gas range cooker & electric oven with slick glass window splashback
- Engineered timber floors to lower living areas, luxuriously carpeted bedrooms and hardwood stairways
- Open plan living areas flow well to hardwood decks, outdoors and garden areas
- Wood combustion burner with floor to ceiling natural stone surround
- 5 zone ducted aircon & ceiling fans throughout for quick easy temperature control
- Approx.63,000 ltr concrete rainwater tank capacity, Bio cycle waste water system, Gas HWS
- Timber and Sandstone retaining walls, room for a caravan, room for a pool & shed
- 15 mins to Noosa's shops, restaurants & beaches, 5 mins to Eumundi & arterial roads

The above information provided has been furnished to us by the vendor/s. We have not verified whether or not that information is accurate and do not have any belief in one way or the other in its accuracy. We do not accept any responsibility to any person for its accuracy and do no more than pass it on. All interested parties should make and rely upon their own inquiries in order to determine whether or not this information is in fact accurate.

31 Whispering Gum Avenue EUMUNDI

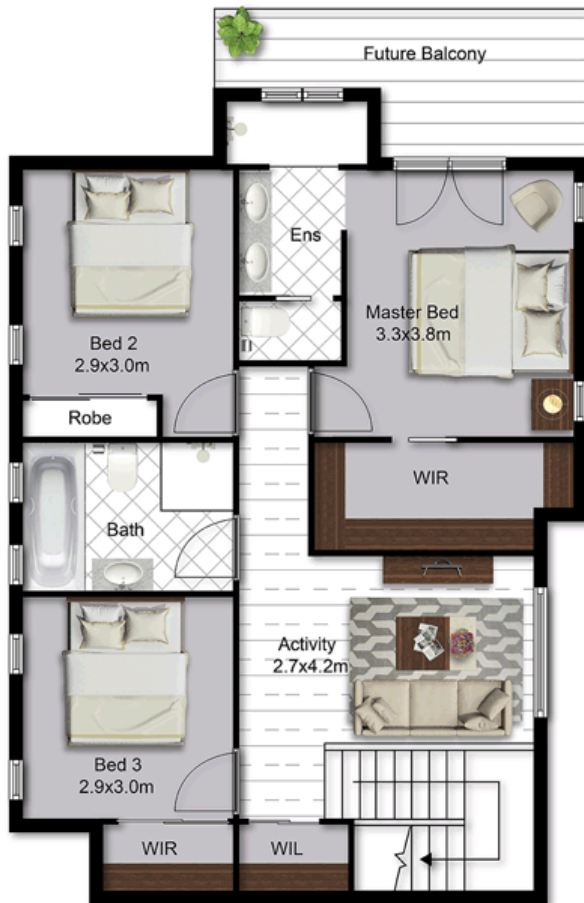

Upper Level



Lower Level

APPROX TOTAL SQM - 259.23

This floor plan is intended as a guide only. Layout dimension are approximate only. No representation or warranties of any nature whatsoever are given or intended. Any person using this information should rely on their own enquiries.